



# DMEGA

Perfect Solution for Suction & Compressor  
in Dental Practice...



Dental Compressor Catalog



# DMEGA PRODUCT

TO SATISFY THE NEEDS OF DENTAL CLINICS...  
DMEGA'S MEGA-AIR SERIES OFFER OIL-FREE  
DENTAL COMPRESSOR WITH SUPERIOR AIR  
QUALITY, RELIABLE AND DURABLE PERFORMANCE.



Mega-Air 1



Mega-Air 2

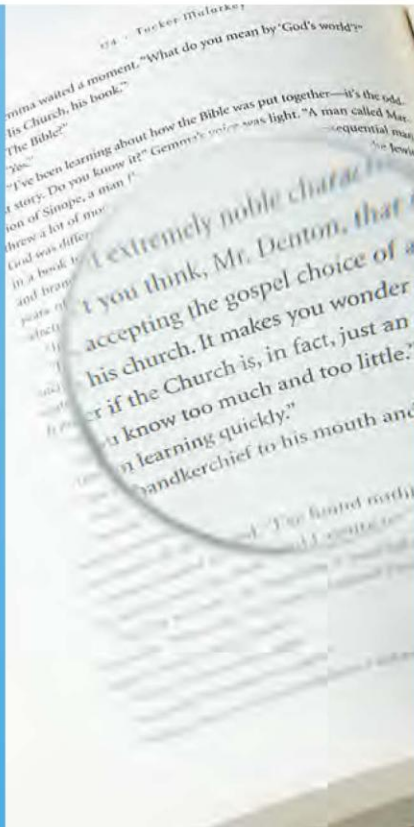

DMEGA is...

Dental Equipment Specialist  
since 1997



# Mega-Air 1

Oil-free dental compressor  
for 1 Unit chair

DMEGA's Oil-free dental compressor, Mega-Air 1 supplies clean air with anti-corrosion coated air receiver tank & superior performance air dryer.

Our Mega-Air 1 series adopts most advanced technology of fresh air intake technology with wool blanket filter, air-shower design and equipped with world-class key components.



For  
1 Surgery



Mega-Air 1C  
(Cabinet type)

## Specification

Model	Mega-Air 1
Compressed air method	Piston
Units chair cover	1 unit
Main power	220V / 50 – 60Hz
Electric motor	0.75kw (1 H.P)
Flow rate (5 bar)	80 Liter / min (50 Hz)
Pressure setting	5 ~ 8 Bar
Tank	24 Liter
Dryer	Installed
Noise level	< 63db
Size	54(L) x 40(W) x 61(H)cm
Weight	38 Kg





## We guarantee superior air quality & minimum maintenance

Air Shower cooling design

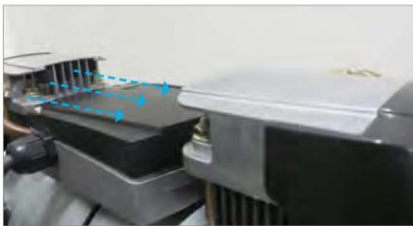

Anti-bacteria filter

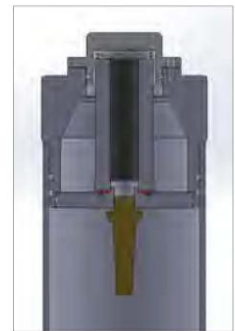

Air In-take Filter (100% wool blanket material)



## Mega-Air Features & Benefits

- **Dust-free cylinder sealing design with wool blanket filter**  
Common problem of wob-L piston type compressor is inflow of dust into cylinder. We design sealing cylinder head and only fresh air inflow through Air in-take filter, so lifetime of cylinder is highly durable, enable to reduce temperature of inside of cylinder compare to any other competition.
- **Air Shower cooling design**  
Motor cooling fan cover extended to cylinder head for cooling down more efficiently.
- **Anti-bacteria filter inside of air dryer**
- **Anti-corrosion coating inside of air receiver tank**
- **Low vibration and noise design**
- **Adopting World class key components for pressure switch, solenoid valve, piston ring, cylinder valve etc...**

# Mega-Air 2

For 2~3  
Surgeries

Oil-free dental compressor  
for 2 ~3 Unit chairs

DMEGA's Oil-free dental compressor, Mega-Air 2 supplies clean air with anti-corrosion coated air receiver tank & superior performance air dryer.

Our Mega-Air 2 series adopts most advanced technology of fresh air intake technology with polyester filter, air-shower design and equipped with world-class key components.



## Specification

Model	Mega-Air 2
Compressed air method	Piston
Units chair cover	2 ~ 3 units
Main power	220V / 50 – 60Hz
Electric motor	1.5kw (2 H.P)
Flow rate (5 bar)	150 Liter / min (50Hz)
Pressure setting	5 ~ 8 Bar
Tank	40 Liter
Dryer	Installed
Noise level	< 65db
Size	63(L) x 45(W) x 80(H)cm
Weight	52 Kg



We present reliable service with minimum service requirements.

Air Shower cooling design



Air In-take Filter  
(Polyester material)



Anti-bacteria filter

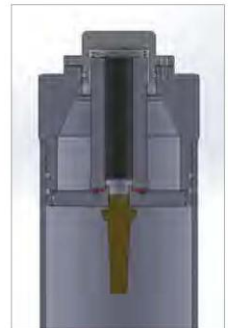

## Mega-Air Features & Benefits

- Dust-free cylinder sealing design with wool blanket filter

Common problem of wob-L piston type compressor is inflow of dust into cylinder. We design sealing cylinder head and only fresh air inflow through Air in-take filter, so lifetime of cylinder is highly durable, enable to reduce temperature of inside of cylinder compare to any other competition.

- Air Shower cooling design

Motor cooling fan cover extended to cylinder head for cooling down more efficiently.

- Anti-bacteria filter inside of air dryer

- Anti-corrosion coating inside of air receiver tank

- Low vibration and noise design

- Adopting World class key components for pressure switch, solenoid valve, piston ring, cylinder valve etc...

# Tera-Air 3/5

Oil-free dental compressor  
for 4 ~8 Unit chairs

For 4~8  
Surgeries



DMEGA proudly introduce Scroll type dental compressor, Tera-Air series that scroll mechanism ensures silent and low-vibration operation, making for a comfortable working environment with state-of-art technology.

It is fully automated with just turning on and off the compressor is all that needs to be done for daily operation.

## Specification

Model	Tera-Air 3	Tera-Air 5
Compressed air method	Scroll	Scroll
Units chair cover	4 ~ 5 units	6 ~ 8 units
Main power	380V / 50 – 60Hz	380V / 50 – 60Hz
Electric motor	2.2kw (3 H.P)	3.7kw (5 H.P)
Flow rate (6 bar)	240 Liter / min (50Hz)	375 Liter / min (50Hz)
Pressure setting	6 ~ 8 Bar	6 ~ 8 Bar
Tank	38 Liter / Stainless steel	38 Liter / Stainless steel
Dryer	Optional	Optional
Noise level	< 55db	< 58db
Size	70(L) x 74(W) x 107(H)cm	70(L) x 74(W) x 107(H)cm
Weight	175 kg	185Kkg





## Compression Principle Of Oil-Free Scroll Compressor

As the orbiting scroll orbits from the No.1 position the No.4 position, a crescent-shaped Compression room at the point of symmetry position is gradually reduced and Compressed through the outlet at the center.

## Oil-Free Scroll Compressors

### Low Noise & Low Vibration

Silent operation and low vibration assure comfortable working environment.

### Clean Air 100% Oil-Free

Our scroll compressor is Oil-Free compressor offering clean air quality, reliability & durability for dental practice.

### Compact & Smart Design

High compression efficiency by the scroll head with teflon provides excellent durability & strong power.



## Main Parts Of Air End



Scroll Head

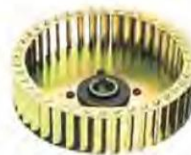

Orbiting Scroll



Fixed Scroll



Sirocco Fan With  
Excellent Cooling Effect



Tip Seal With  
High Air tightness

# CLEBO

Total Solution For Dental Practice

Dental clinic always care about clinical space. Clebo is combined system incorporate both DMEGA compressor & Teravac suction system. Clebo can be combined with customer's needs for 1~6 surgeries. The measurement of Clebo could be different according to customer's selection of compressor model.



# Tera-Air Max

Large Dental Hospitals And University Hospitals Compressor



**For  
Large  
Clinics**

- For 30~40 dental units
- For large dental hospitals and university hospitals (Central compressor system)
- Several compressor motors are installed in one unit
- Motors operate automatically according to the use of volume
- 1~2 motors operate when the use of volume decreases, 4 motors operate when the use of volume increases
- If some motors stop, other motors can back up automatically
- Monitoring system & alarming function is equipped.

## Specification

Tera-Air Max	Main Power	Compressed air method	Unit chair covered	Electric Motor	Flow rate (6 bar)	Pressure setting	Noise level	Size	Weight
	380V, 3 phase	Scroll	30 ~ 40	3.7kw x 4ea (20 H.P)	1500 L/min	6 ~ 8 bar	<59db	72×114×164 (L,W,H)cm	510kg

## Suction

Image	Model	Surgery	Description
	S 101	1	Semi-wet Suction with Separator
	S 101C	1	Semi-wet Suction with Separator / S101 cabinet type
	Megavac 2000	2	Semi-wet Suction with Separator
	Megavac 2000A	1 ~ 2	Semi-wet Suction with Separator & Amalgam separator
	Teravac 3000	1 ~ 3	Semi-wet Suction with Separator & Inverter function
	Teravac 5000	4 ~ 5	Semi-wet Suction with Separator & Inverter function
	Teravac 6000	5 ~ 6	Semi-wet Suction with Separator & Inverter function
	Mega Power	2 ~ 3	Liquid Ring Vacuum pump

## DMEGA Product List

## Compressor

Image	Model	Surgery	Description
	Mega-Air 1	1	1HP Piston Type Oil-free dental Compressor / with dryer
	Mega-Air 1C	1	1HP Piston Type Oil-free dental Compressor / with dryer, Cabinet
	Mega-Air 2	2 ~ 3	2HP Piston Type Oil-free dental Compressor / with dryer
	Tera-Air 3	4 ~ 5	3HP Scroll Type Oil-free dental Compressor / with dryer
	Tera-Air 5	6 ~ 8	5HP Scroll Type Oil-free dental Compressor / with dryer
	Tera-Air Max	30 ~ 40	20HP Scroll Type Oil-free dental Compressor

## Central Suction for Hospital

Image	Model	Surgery	Description
	Tera-Max 3	44 ~ 60	10HP Central Dry Suction with Separation Tank & Inverter controlled Panel / Spare Back-up motor
	Tera-Max 4	66 ~ 90	15HP Central Dry Suction with Separation Tank & Inverter controlled Panel / Spare Back-up motor
	Tera-Max 5	88 ~ 120	20HP Central Dry Suction with Separation Tank & Inverter controlled Panel / Spare Back-up motor